

## Drive Alignment

- Use a straight edge to check the alignment of the pulleys.
- If a belt tensioner is installed, check alignment of belt on idler pulley, it should be centered on the idler pulley.
- If an adjustment is needed, remove the belt, then loosen the set screw in one pulley and move it.
- Remember to tighten the set screw after making an adjustment.
- Drive alignment is very important for long belt life and proper operation.

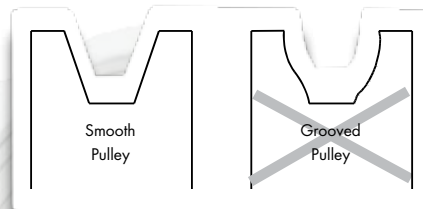
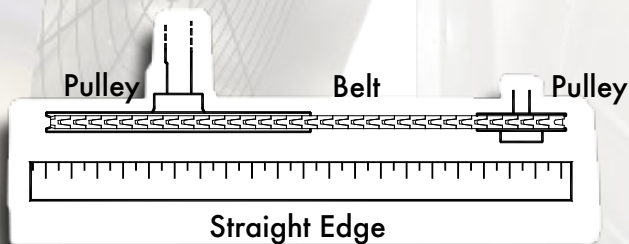
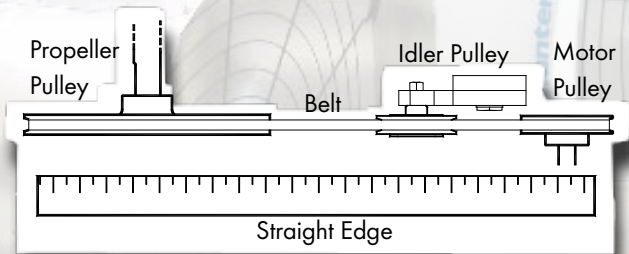

## Checking Pulleys

- Roll the belt off and look at both pulleys.
- If the pulley has grooves in it or is no longer smooth, it needs replacement.
- A loose or slipping belt will reduce fan performance up to 60% and cause premature belt failure.



## Belt Tension

- All belts must be checked for proper tension after the first 3 days of fan operation and every 4-6 months after first inspection.

### Check belt tension on Configuration 1 or 2:

- Roll the belt off the pulleys by forcing it sideways off the larger pulley as you turn the drive by hand.
- Reinstall the belt by wrapping it around the smaller pulley and then starting it over the top of the larger pulley.
- As you continue rolling it onto the larger pulley, the belt should become tight in the positions shown.
- If the belt becomes tight before reaching the positions shown, add one link and try again.
- If the belt is still loose when in the position shown, remove one link and try again.

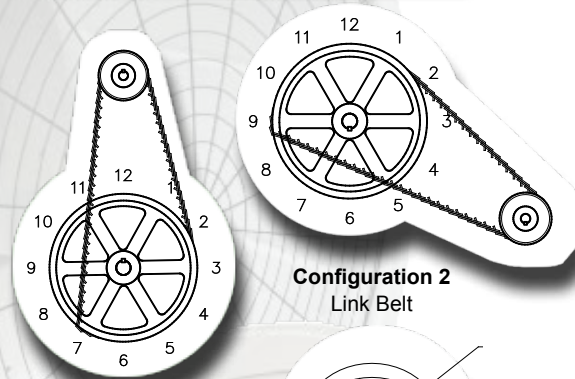
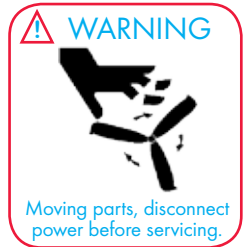

Configuration 1 Link Belt

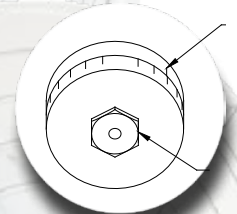

### Check belt tension on Configuration 3:

- The alignment mark is between marks 2 and 4 on the right of the belt tensioner.
- Check condition of belt, if worn, replace belt. If belt is good then make adjustment as needed.
- Loosen bolt fastening the tensioner to the tensioner bracket and place a wrench onto the large hex on the tensioner.
- Turn the wrench clockwise until the **alignment mark** is as follows:  
 Pillow Block bearing -AT: (36-48") -AX: (36-51") -GB: (36-48") -VX: (51-55") -AT: (36-48")  
 Hub bearing -WF: (50")  $\frac{1}{2}$  -WF: (54")
- Hold tensioner at this setting and tighten the bolt fastening the tensioner to the belt tensioner bracket.

# Fan Maintenance

## Check Fasteners

- Check tightness of all fasteners.
- Visually check fan for any signs of damage, such as motor mounts, propeller, housing, etc.

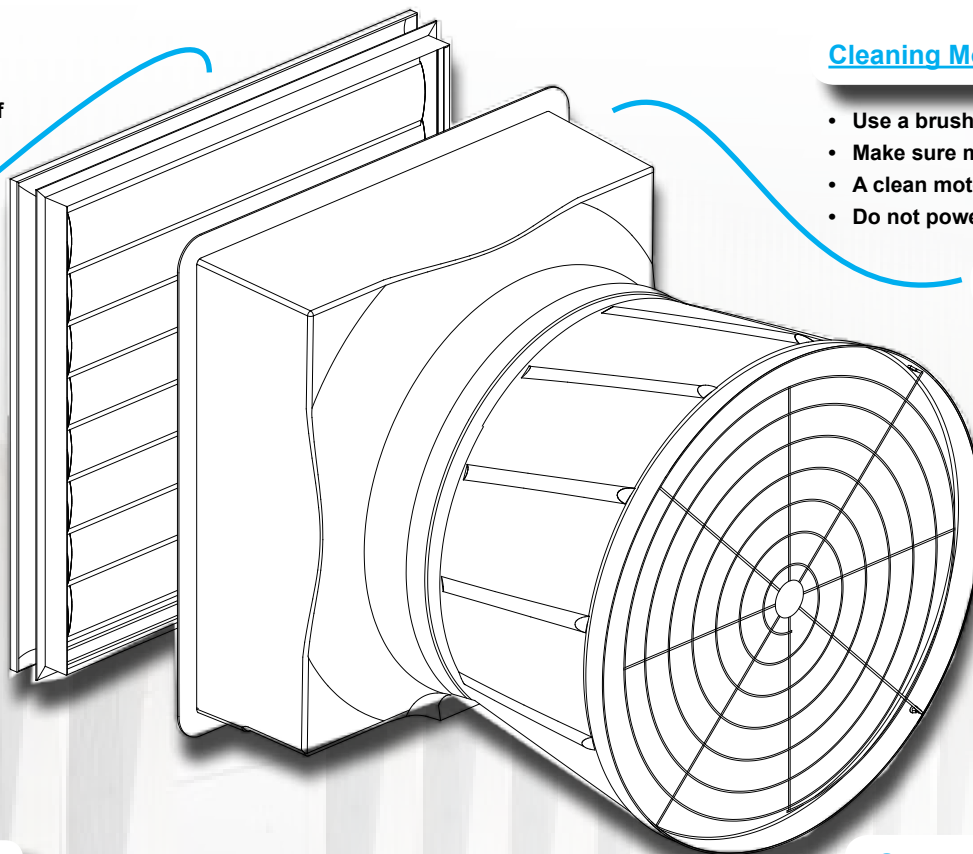

## Cleaning Shutter

- Use a brush or cloth to clean dust from shutter blades and frame.
- Make sure the shutter will open and close easily.
- A dirty shutter will reduce airflow by as much as 40%.

## Variable Speed Adjustment

- Use a digital or photo tachometer to set proper fan speed (RPM: propeller revolutions per minute).
- Some photo tachometers require you to take the reading displayed and divide by the number of blades on the propeller.
- Incorrect RPM results in a change of airflow and can change the animal's comfort level.

## Cleaning Motor

- Use a brush or cloth to wipe dust from the motor
- Make sure motor is secure in its mount.
- A clean motor will run cooler and last longer.
- Do not power wash - Motor is not wash down duty.

## Cleaning Housing

- Wipe dust from bottom of the housing.
- Make sure the drain holes are clean.
- The outside of the housing can be cleaned with mild soap and water. **No Abrasives.**

## Cleaning Guard

- Use a brush or broom to wipe dust or feathers from the guards.
- Verify that guard is secure.
- Dirty guards will reduce airflow.

## Grease Pillow Block Bearings

- Use no more than 2 shots when greasing fans.
- A premium non-water based grease is recommended:
  - Shell Alvania #2
  - Mobil Mobilux #2
  - Exxon Unirex N2
  - Texaco Premium RB
  - Mobil 532
  - Texaco Multifak #2
- Grease bearings every 4-6 months.
- No grease is required on WF- Models

